

# 6022-2RS1 Deep groove ball bearings

- Popular item  
- SKF Explorer

## Deep groove ball bearings

### Bearing data

[Tolerances](#),

Normal (metric), P6, P5, Normal (inch),

[Radial internal clearance](#),

Matched bearing pairs, Stainless steel  
d < 10 mm, Other bearings

### Bearing interfaces

[Seat tolerances for standard conditions](#),

[Tolerances and resultant fits](#)

## Technical specification

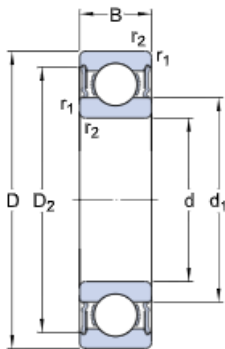

### DIMENSIONS

d	110 mm	Bore diameter
D	170 mm	Outside diameter
B	28 mm	Width
d <sub>1</sub>	≈ 129.05 mm	Shoulder diameter
D <sub>2</sub>	≈ 155.3 mm	Recess diameter
r <sub>1,2</sub>	min. 2 mm	Chamfer dimension

### ABUTMENT DIMENSIONS

d <sub>ε</sub> min.	119 mm	Diameter of shaft abutment
d <sub>ε</sub> max.	128.9 mm	Diameter of shaft abutment
D <sub>ε</sub> max.	161 mm	Diameter of housing abutment
r <sub>a</sub> max.	2 mm	Radius of shaft or housing fillet

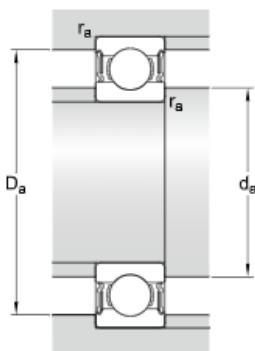

## CALCULATION DATA

C	85.2 kN	Basic dynamic load rating
C <sub>0</sub>	73.5 kN	Basic static load rating
P <sub>u</sub>	2.6 kN	Fatigue load limit
	2 400 r/min	Limiting speed
k <sub>r</sub>	0.025	Minimum load factor
f <sub>0</sub>	15.6	Calculation factor

## MASS

	2.02 kg	Mass bearing
--	---------	--------------

## TOLERANCE CLASS

P6	Dimensional tolerances
Normal	Radial run-out